

Alternative 5

170th Ave./ 173rd Ave. Project Baseline Rd. to Walker Rd.



Baseline to Walker Project



DAVID EVANS AND ASSOCIATES INC.
2100 Southwest River Parkway
Portland Oregon 97201
Phone: 503.223.6663

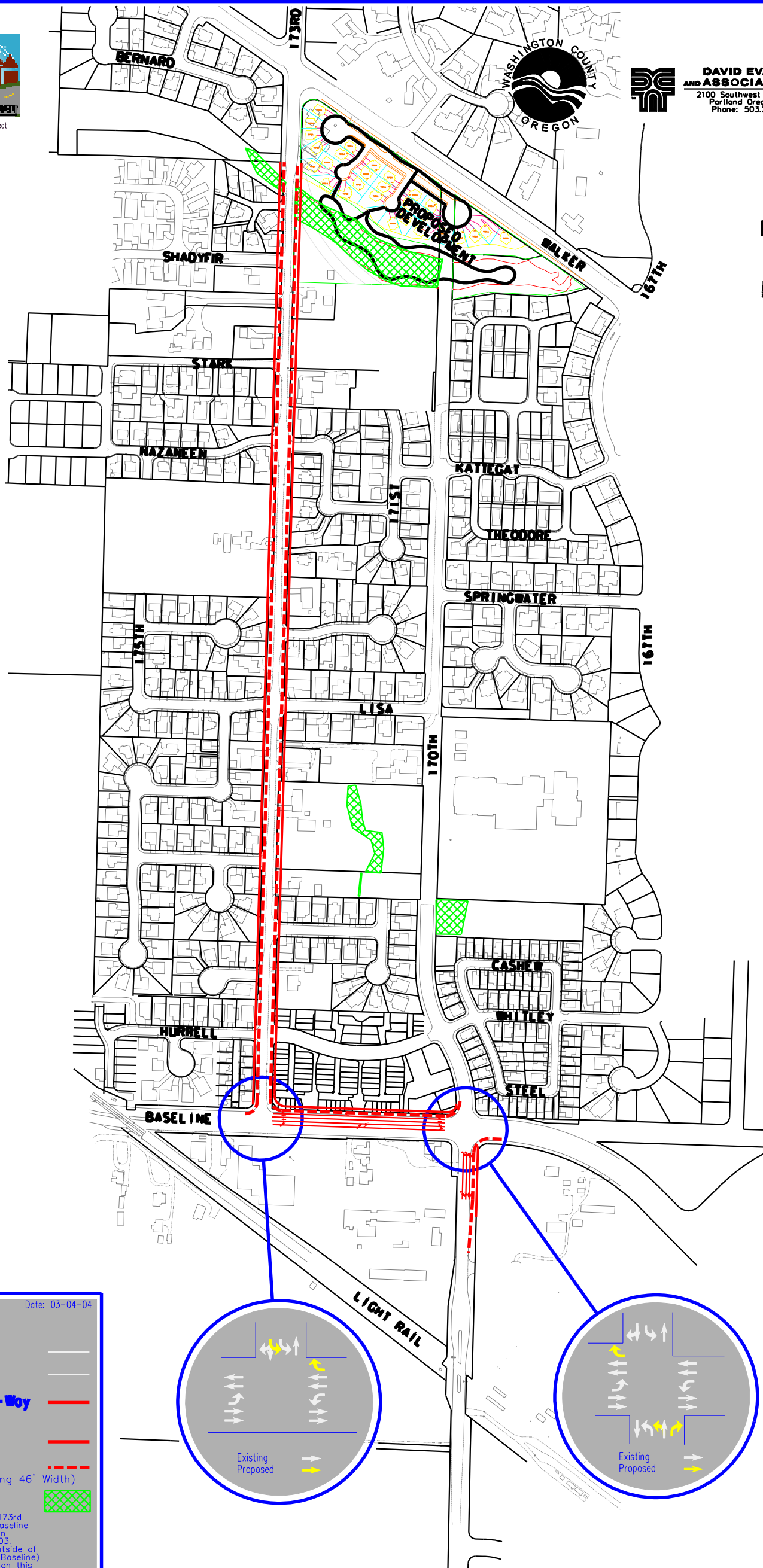

Date: 03-04-04

Legend

- Property Line ———
- Right of Way Line ———
- Proposed Right-of-Way (Showing 74' Width) ———
- Centerline of Road ———
- Proposed Curb (3 Lane Sect. - Showing 46' Width) - - - - -
- Wetland Boundary (Wetlands within the 170th/173rd limits between Walker and Baseline are based on field delineation conducted by DEA on 7-1-03. Other wetlands may exist outside of the 170th/173rd (Walker to Baseline) corridor and are not shown on this map.)

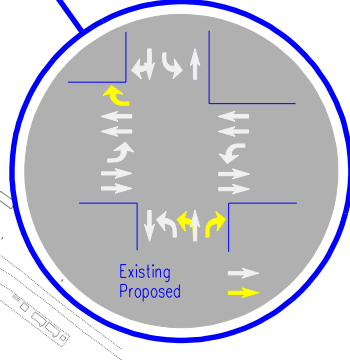
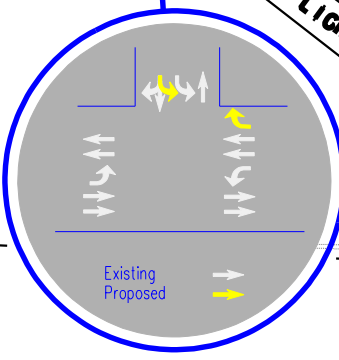

LIGHT RAIL